

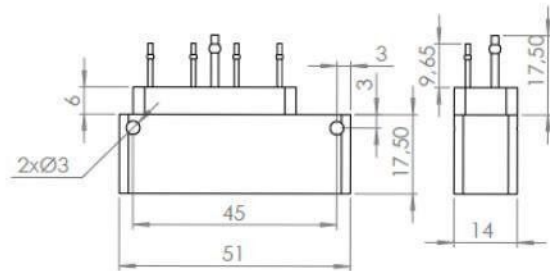

4xPDIF-S

4-Channel differential pressure sensor for CAN Bus with scanivalve connectors

Range	+/- 50 to +/- 1000 mBars +/- 0.7 to +/- 15 PSI
Sensitive element	Piezo resistive Cells
Accuracy at FS	+/- 0.5 % FS
Non linearity/ Hysteresis	+/- 0.7 % FS
Offset Drift	+/- 0.5 % FS
Sensitivity drift	0.5 %
Sampling Frequency SF	200 Hz
CAN bus 2.0A or B	120 Ω, not installed (on demand)
Output data	2 bytes per channel (signed int)
Unit	1 mPSI / bit 0.1 mBar / bit
Baud rate	125 k to 1 Mbps
Data frequency	1 to 200 Hz or on trigger
Supply voltage	6 to 16 V
Supply current	30 mA
Dimension	51 x 35 x 14 mm
Material	Aluminium
Weight	25 g
Vibration test	200 Gpp 5'
Shock	500 G
Operating temp	+5 to +85 °C
Storage temp	-40 to +124 °C



Ordering ref.:

4xPDIF-S-CAN-1- Range(mbar)- diameter-Option

Range	50 :	±50mBar
	350 :	±350mBar
	1000 :	±1000mBar
Diameter	40 :	Pressurette diameter 0.40
	63 :	Pressurette diameter 0.63
Option	N :	None
	Z :	Auto-Zero

Ex: 4xPDIF-S-CAN-1-350-63-N

1 m cable of 4 X 26AWG FEP
tinned copper braided cable 250 V 200°C

Colour	Function	Pin
Red	Supply	
Black	0V	
Green	CAN High	
White	CAN Low	
Yellow	Do not connect and isolate	
Braid		